

Spacing insulators made in polyglass polyester material reinforced with fiberglass, red colour. On request we can supply the spacing insulators with 1 or 2 male connections type «AM».

Séparateurs isolants fabriqués en polyverre, polyester renforcé de fibres de verre de couleur rouge. Sur demande nous pouvons fournir des isolateurs avec 1 ou 2 inserts mâles – ref AM.

Spatieisolatoren vervaardigd uit polyglas polyester met glasvezelversterking in rode kleur. Op aanvraag kunnen wij isolatoren leveren met 1 of 2 draadstangen - ref AM.

CO/P

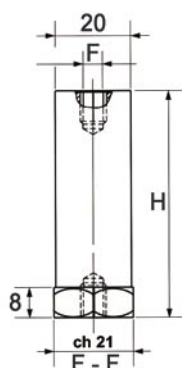

| | |
|---|--------------------|
| Operating Temperature Température d'utilisation Gebruikstemperatuur | -40°C +130°C |
| Fire Reaction Tenue au feu Vuurbestendigheid | Class UL94-VO |
| Breaking charge Charge de rupture Breukweerstand | Tolerance +/- 10 % |

| Art. | F | H | Service Voltage |
|---------|-------------------|-------|-----------------|
| CO/P 16 | M4 - M5 - M6 | 16 mm | 220 V |
| CO/P 20 | M4 - M5 - M6 - M8 | 20 mm | 400 V |
| CO/P 25 | M5 - M6 - M8 | 25 mm | 500 V |
| CO/P 30 | M5 - M6 - M8 | 30 mm | 600 V |
| CO/P 35 | M5 - M6 - M8 | 35 mm | 600 V |
| CO/P 40 | M6 - M8 | 40 mm | 600 V |
| CO/P 45 | M6 - M8 | 45 mm | 750 V |
| CO/P 50 | M6 - M8 | 50 mm | 750 V |
| CO/P 60 | M6 - M8 | 60 mm | 750 V |

| Art. | Surface flashover Surcharge /surface Overbelasting opp. | Intern. flashover Surcharge intern. Inwend. overbelast. | Tensile stress Traction Trek. | Cantilever stress Flexion Buiging | Comp. stress Compression Druk | Twist. stress Torsion Torsie |
|---------|---|---|-------------------------------------|---|-------------------------------------|------------------------------------|
| | kV (A.C.) | kV (A.C.) | DN | DN | DN | DN x m |
| CO/P 30 | 5 | 15 | 400 | 200 | 2100 | 1-2 |
| CO/P 40 | 8 | 20 | 400 | 150 | 2100 | 1-2 |
| CO/P 50 | 10 | 25 | 400 | 100 | 2100 | 1-2 |
| CO/P 60 | 10 | 30 | 400 | 100 | 2100 | 1-2 |

CS/P

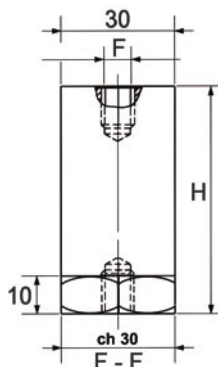

| | |
|---|--------------------|
| Operating Temperature Température d'utilisation Gebruikstemperatuur | -40°C +130°C |
| Fire Reaction Tenue au feu Vuurbestendigheid | Class UL94-VO |
| Breaking charge Charge de rupture Breukweerstand | Tolerance +/- 10 % |

| Art. | F | H | Service Voltage |
|---------|---------------|-------|-----------------|
| CS/P 30 | M6 - M8 - M10 | 30 mm | 750 V |
| CS/P 35 | M6 - M8 - M10 | 35 mm | 1000 V |
| CS/P 40 | M6 - M8 - M10 | 40 mm | 1000 V |
| CS/P 45 | M6 - M8 - M10 | 45 mm | 1000 V |
| CS/P 50 | M6 - M8 - M10 | 50 mm | 1500 V |
| CS/P 55 | M6 - M8 - M10 | 55 mm | 1500 V |
| CS/P 60 | M6 - M8 - M10 | 60 mm | 1500 V |
| CS/P 65 | M6 - M8 - M10 | 65 mm | 1500 V |
| CS/P 70 | M6 - M8 - M10 | 70 mm | 1500 V |

| Art. | Surface flashover Surcharge /surface Overbelasting opp. | Intern. flashover Surcharge intern. Inwend. overbelast. | Tensile stress Traction Trek. | Cantilever stress Flexion Buiging | Comp. stress Compression Druk | Twist. stress Torsion Torsie |
|---------|---|---|-------------------------------------|---|-------------------------------------|------------------------------------|
| | kV (A.C.) | kV (A.C.) | DN | DN | DN | DN x m |
| CS/P 30 | 8 | 20 | 900 | 450 | 4000 | 1,3 - 2,6 |
| CS/P 40 | 8 | 25 | 900 | 300 | 4000 | 1,3 - 2,6 |
| CS/P 50 | 10 | 35 | 900 | 200 | 4000 | 1,3 - 2,6 |
| CS/P 60 | 15 | 35 | 900 | 150 | 4000 | 1,3 - 2,6 |

CT/P

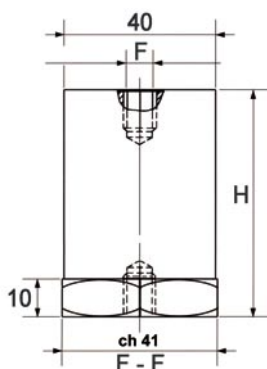

| | |
|---|--------------------|
| Operating Temperature Température d'utilisation Gebruikstemperatuur | -40°C +130°C |
| Fire Reaction Tenue au feu Vuurbestendigheid | Class UL94-VO |
| Breaking charge Charge de rupture Breukweerstand | Tolerance +/- 10 % |

| Art. | F | H | Service Voltage |
|---------|----------|-------|-----------------|
| CT/P 30 | M8 - M10 | 30 mm | 750 V |
| CT/P 35 | M8 - M10 | 35 mm | 750 V |
| CT/P 40 | M8 - M10 | 40 mm | 1000 V |
| CT/P 45 | M8 - M10 | 45 mm | 1000 V |
| CT/P 50 | M8 - M10 | 50 mm | 1500 V |
| CT/P 55 | M8 - M10 | 55 mm | 1500 V |
| CT/P 60 | M8 - M10 | 60 mm | 1500 V |
| CT/P 65 | M8 - M10 | 65 mm | 1500 V |
| CT/P 70 | M8 - M10 | 70 mm | 1500 V |
| CT/P 80 | M8 - M10 | 80 mm | 1500 V |

| Art. | Surface flashover Surcharge /surface Overbelasting opp. | Intern. flashover Surcharge intern. Inwend. overbelast. | Tensile stress Traction Trek. | Cantilever stress Flexion Buiging | Comp. stress Compression Druk | Twist. stress Torsion Torsie |
|---------|---|---|-------------------------------------|---|-------------------------------------|------------------------------------|
| | kV (A.C.) | kV (A.C.) | DN | DN | DN | DN x m |
| CT/P 30 | 8 | 20 | 1000 | 750 | 8000 | 3 - 6 |
| CT/P 40 | 10 | 25 | 1000 | 750 | 8000 | 3 - 6 |
| CT/P 50 | 10 | 35 | 1000 | 750 | 8000 | 3 - 6 |
| CT/P 60 | 10 | 35 | 1000 | 750 | 8000 | 3 - 6 |